

Assembly Instructions

Linear LCD graphic panel



Male post x 2
(weight 1kg approx)



Steel oval base & M10 bolt x 2
(weight 4kg approx)



PVC clear washer x 1



Allen Key



Female post x 2
(weight 1kg approx)



1000mm beam x 4
(weight 1kg approx)



Please note that the above kit is based on a - 2000mm(h) x 1000mm(w) x 400mm(d)

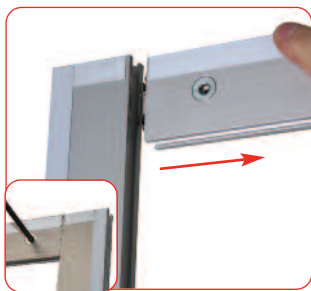

Attach horizontal beams to the vertical frame sides. Tighten locks using a 5mm allen key. If using rigid infill graphics, slide these in to position before tightening beams.



Screen not applicable on this model



To attach the PVC wing simply cut the PVC wing to the required length, click the PVC wing into the channel on the linear until fully secure

Important: Once frame is complete apply steel tape around the frame and PVC extrusion

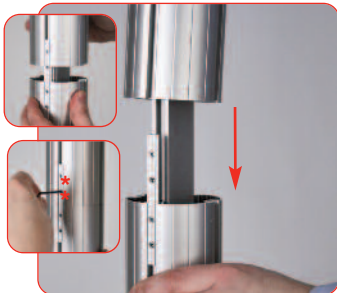

Align and slide female post over male post, tighten both grub screws using a 2mm allen key.



Attach base to male post using M10 bolt and allen key. Ensure clear washer is between base & post. Repeat step for 2nd post.