

Assembly Instructions

Important: Ensure fingers are kept clear of folding mechanism when opening and closing the unit

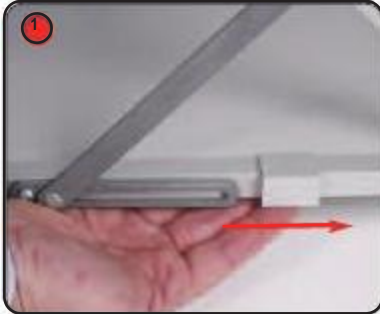

Slide locking tab away from pivot arm at base of unit. Repeat for 2nd locking tab.



Whilst raising the unit note position of the pivot arms. To ensure correct assembly both pivot arms must rotate through 180 degrees.

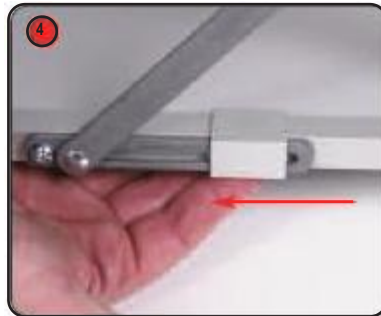

Slide locking tab over pivot arm at base of unit. Repeat for 2nd locking tab.

